

## Get to Know the *Superlab* Scavenger Hunt

### A1. Safety (see your Provincial Learning Outcomes Checklist)

Superlab Feature	Label to use on diagram:	What's it for? Give details.
Fume hood	FH	
Lab Prep Area	LPA	
Fire Extinguishers (3)	FE	
Eye wash station (2)	EW	
Emergency Shower (2)	ES	
Safety glasses	SG	
Dissection equipment	DE	
Lab area 1 - Biology Lab area 2 - Chemistry Lab area 3 - Chemistry Lab area 4 - Physics	Bio Chem Chem Physics	
Incubator	I	
Gas taps	GT	
Microscope location	M	
Blackout curtain	BO	
Broken Glassware bucket	GW	
Emergency Gas Valve Shutoff	EGSO	

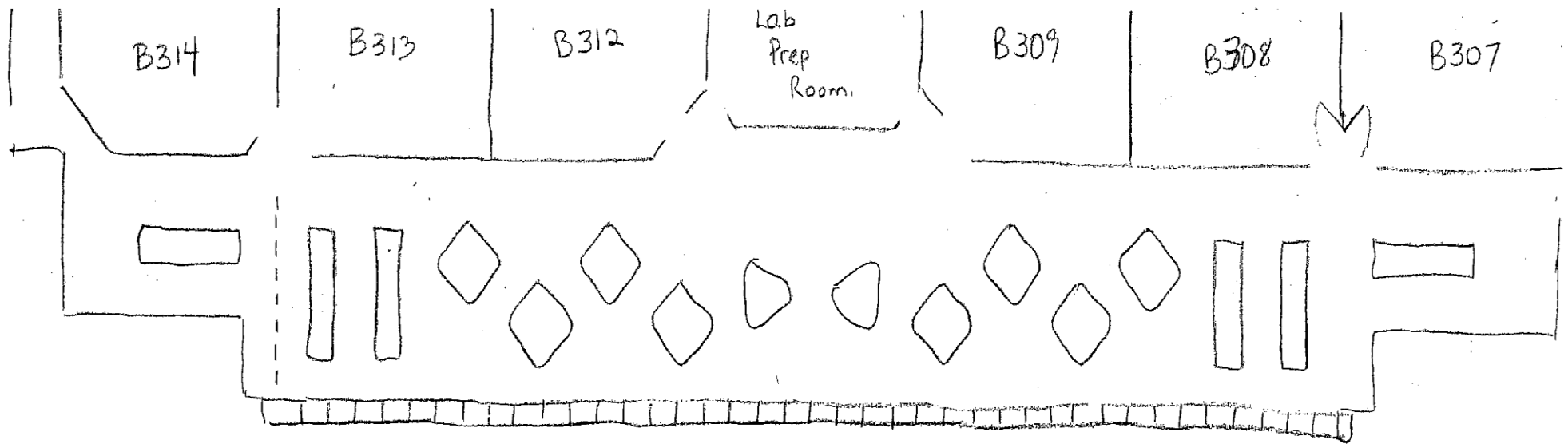

Questions:

1. Describe in detail when and how each of the following would be used:

- a. Fume hood
- b. Fire extinguisher
- c. Eye wash station
- d. Emergency shower
- e. Broken glassware bucket
- f. Safety glasses

2. How should dissection equipment be put away? Describe in detail.
3. Explain how you know a gas tap is in the off position or the on position. Draw a diagram if it helps you remember.
4. How should glassware be put away?
5. Explain clean up procedures in the Superlab.
6. Where is the first aid kit located? Label it on your diagram.
7. Once you complete a lab and have cleaned up, you will have to wait until **everyone** is done before returning to class. What should you do while you wait?

## Safety

- Find the section in your textbook titled, "Safety in Your Science Classroom".
- Read carefully.
- Use your coiled notebook for the following:
  - Select a method or methods (or another method that you know works for you) of helping you sort out the information so that you will remember it:
    - Fishbone
    - Concept map
    - Notes with diagrams, headings, subheadings
    - Pictographs
    - Pictures with labels
    - Charts
- We will also be doing a whiteboarding activity in class that involves selecting the 3 most important rules, so be thinking about this as you create your learning resource.
- As with all the material in this package, we will be practicing it as formative assessment. In the end, you will write a summative assessment that will count toward your grade.