

Get to Know the *Superlab*

Label the diagram below with the Superlab features listed. Then explain what each feature is used for.

Superlab Feature	Label to use on diagram:	What's it for?
Fume hood	FH	
Fire blanket	FB	
Fire Extinguisher	FE	
Eye wash station	EW	
Emergency Shower	ES	
Safety glasses	SG	
Dissection equipment	DE	
Work area 1 - Biology	W1 - Bio	
Work area 2 - Chemistry Work area 3 - Chemistry	W2 - Chem W3 - Chem	
Work area 4 - Physics	W4 - Physics	
Gas taps	GT	
Microscope location	M	
Blackout curtain	BO	
Glassware	GW	
Our classroom	CR	

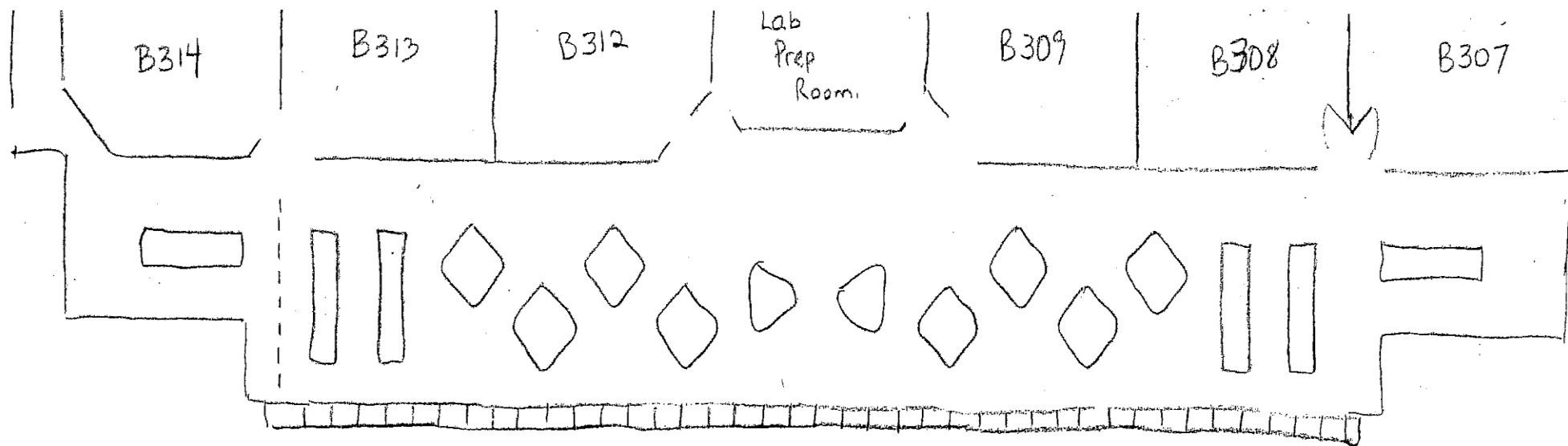

Questions:

1. Describe in detail when and how each of the following would be used:

a. Fire blanket

b. Fire extinguisher

c. Eye wash station

d. Emergency shower

2. Explain how you know a gas tap is in the off position or the on position. Draw a diagram if it helps you remember.
3. How should glassware be put away?
4. Explain clean up procedures in the Superlab.
5. Once you complete a lab and have cleaned up, you will have to wait until **everyone** is done before returning to class. What should you do while you wait?