

Get to Know the *Superlab* Scavenger Hunt

Label the diagram below with the Superlab features listed. Then explain what each feature is used for.

Superlab Feature	Label to use on diagram:	What's it for?
Fume hood	FH	
Lab Prep Area	LPA	
Fire Extinguishers (3)	FE	
Eye wash station (2)	EW	
Emergency Shower (2)	ES	
Safety glasses	SG	
Dissection equipment	DE	
Lab area 1 - Biology Lab area 2 - Chemistry Lab area 3 - Chemistry Lab area 4 - Physics	Bio Chem Chem Physics	
Incubator	I	
Gas taps	GT	
Microscope location	M	
Blackout curtain	BO	
Broken Glassware bucket	GW	
Emergency Gas Valve Shutoff	EGSO	

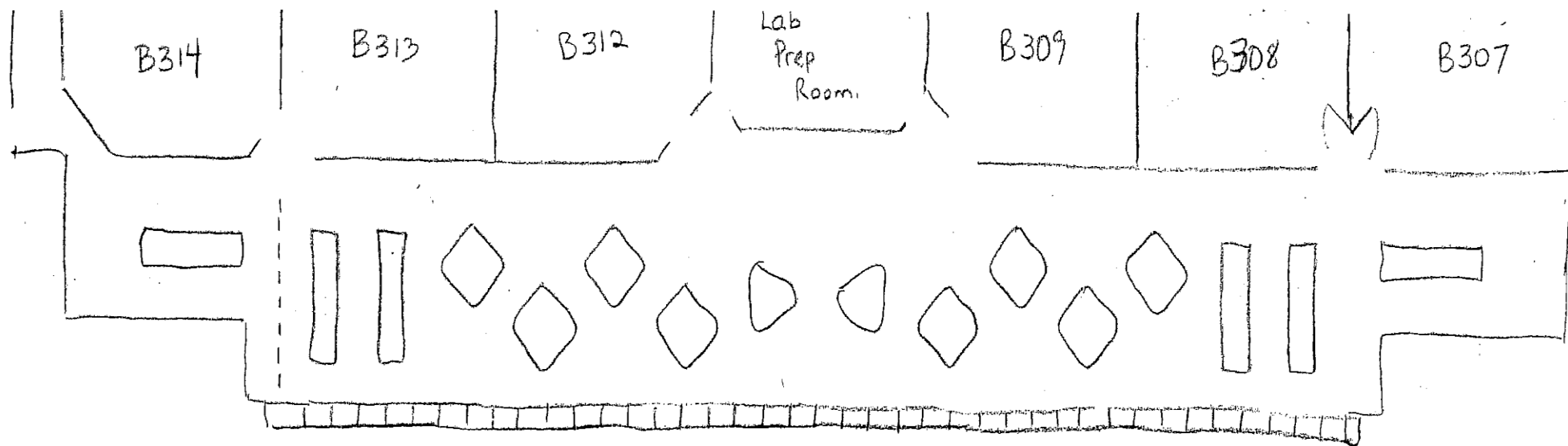

Questions:

1. Describe in detail when and how each of the following would be used:

a. Fire blanket

b. Fire extinguisher

c. Eye wash station

d. Emergency shower

2. How should dissection equipment be put away? Describe in detail.
3. Explain how you know a gas tap is in the off position or the on position. Draw a diagram if it helps you remember.
4. How should glassware be put away?
5. Explain clean up procedures in the Superlab.
6. Once you complete a lab and have cleaned up, you will have to wait until **everyone** is done before returning to class. What should you do while you wait?

Lab Behavior

The Prescribed Learning Outcome that deals with proper lab behavior is _____. Summarize it.